

(2) Remove quarter trim panel. (Refer to 23 - BODY/INTERIOR/QUARTER TRIM PANEL - REMOVAL)

(3) Remove the nuts. (Fig. 7)

(4) Remove the front bolts.

(5) Remove the screws and remove the center track end piece. (Fig. 8)

(6) Using a heat gun or equivalent, heat track up to approximately 60° C (140° F).

(7) Remove center track.

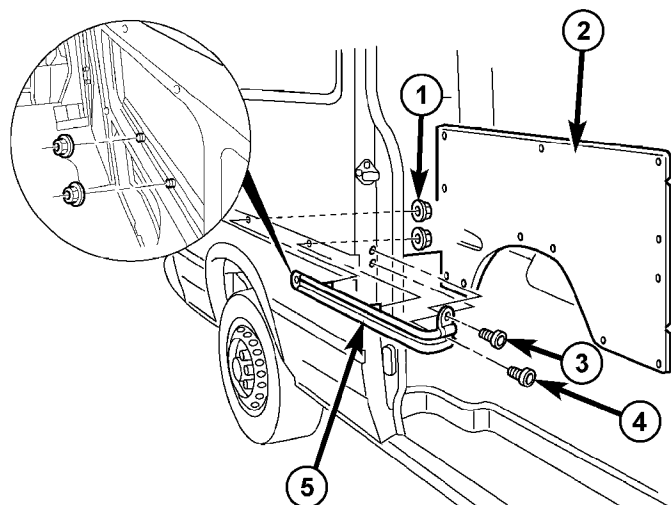

811194cc

**Fig. 7 SLIDING DOOR CENTER TRACK**

- 1 - NUTS
- 2 - QUARTER TRIM PANEL
- 3 - BOLT
- 4 - BOLT
- 5 - CENTER TRACK

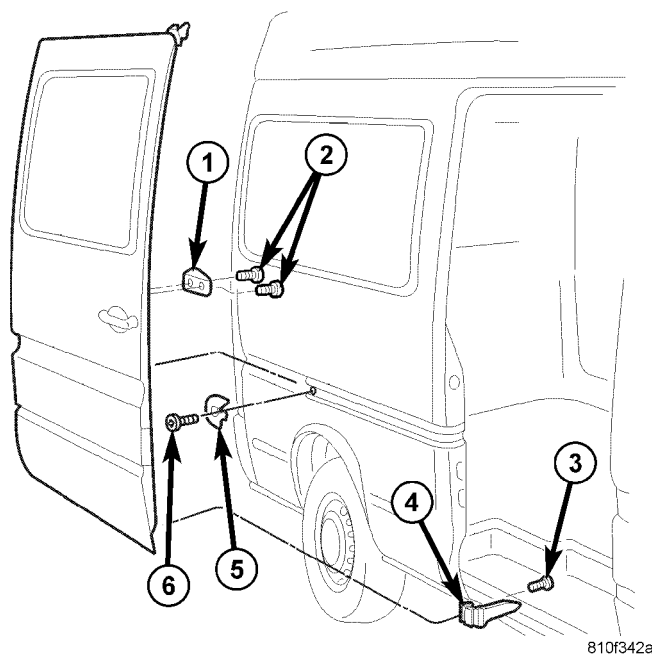

810F342a

**Fig. 8 SLIDING DOOR**

- 1 - STOP BUMPER
- 2 - SCREWS (2)
- 3 - SCREWS (2)
- 4 - LOWER ROLLER ARM
- 5 - END PIECE
- 6 - SCREWS (2)

## INSTALLATION

(1) Thoroughly clean all residue from the center track attachment area of the door.

(2) Wipe area clean with a 50% solution of water and alcohol and wipe dry.

(3) Remove protective foil from piece of adhesive strip on center track.

(4) Apply new center track and apply pressure of approximately 40 p.s.i. over the entire surface of the track.

(5) Install the front bolts and tighten to 10 N·m (89 in. lbs.).

(6) Install the interior nuts and tighten to 10 N·m (89 in. lbs.).

(7) Install quarter trim panel. (Refer to 23 - BODY/INTERIOR/QUARTER TRIM PANEL - INSTALLATION)

(8) Install the center roller arm. (Refer to 23 - BODY/DOORS - SLIDING/CENTER ROLLER ARM - INSTALLATION)

(9) Install the center track end piece and install the screw.

## LATCH / LOCK CONTROL

### REMOVAL

- (1) Disconnect and isolate battery negative cable.

- (2) Remove trim panel. (Refer to 23 - BODY/DOORS - SLIDING/TRIM PANEL - REMOVAL)
- (3) Disconnect electrical connectors. (Fig. 9)
- (4) Remove bolts and remove control assembly. (Fig. 10)
- (5) Disconnect lock knob rod. (Fig. 11)
- (6) Disconnect cable.

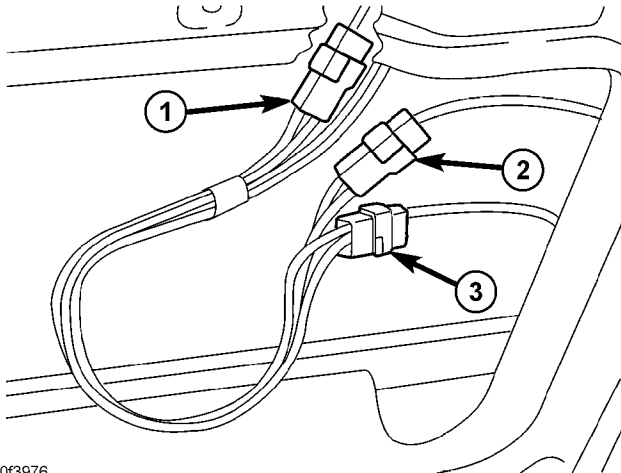

810f3976

**Fig. 9 ELECTRICAL CONNECTORS**

- 1 - CONNECTOR
- 2 - CONNECTOR
- 3 - CONNECTOR

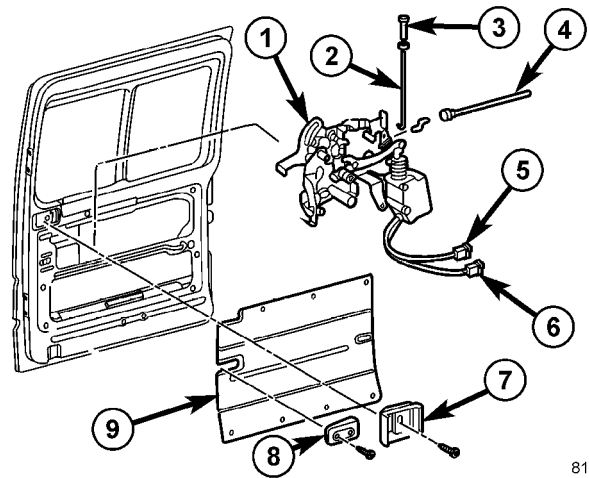

810f3a86

**Fig. 11 LOCK ASSEMBLY**

- 1 - LATCH/LOCK CONTROL ASSEMBLY
- 2 - LOCK ROD
- 3 - LOCK KNOB
- 4 - LATCH CONTROL CABLE
- 5 - ELECTRICAL CONNECTOR
- 6 - ELECTRICAL CONNECTOR
- 7 - INTERIOR HANDLE ACTUATOR
- 8 - STOP BUMPER
- 9 - TRIM PANEL

**INSTALLATION**

- (1) Position latch/lock control assembly at door and connect the latch control assembly and lock rod.
- (2) Install assembly and install new bolts. Make sure that the lever of the door handle is in front of the lever of the inside door lock. (Fig. 12)

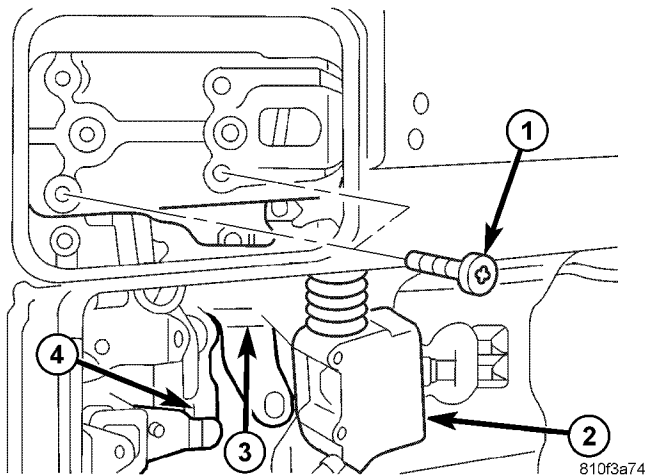

810f3a74

**Fig. 10 LOCK ASSEMBLY FASTENERS**

- 1 - SCREWS
- 2 - POWER LOCK ACTUATOR
- 3 - LATCH/LOCK CONTROL ASSEMBLY
- 4 - EXTERIOR DOOR LEVER

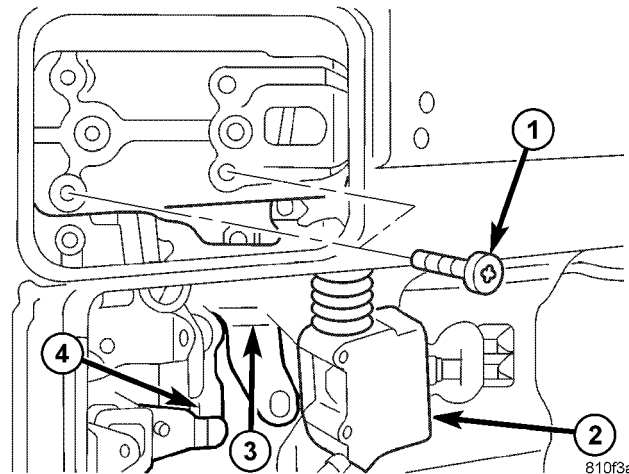

810f3a74

**Fig. 12 LOCK ASSEMBLY FASTENERS**

- 1 - SCREWS
- 2 - POWER LOCK ACTUATOR
- 3 - LATCH/LOCK CONTROL ASSEMBLY
- 4 - EXTERIOR DOOR LEVER

- (3) Tighten bolts to 10 N·m (89 in. lbs.).
- (4) Connect electrical connectors.
- (5) Install trim panel. (Refer to 23 - BODY/DOORS - SLIDING/TRIM PANEL - INSTALLATION)
- (6) Connect battery negative cable.